

POCKET TARGET

OPERATING INSTRUCTIONS

Safety measures.

- Before use, carefully read the instruction manual equipment.
- Use only in accordance with the Operating Instructions.
- Use only for the purpose for which it is intended.
- Never aim at people or animals in uncontrolled space.
- When handling weapons follow the general rules for handling weapons.
- Pocket target is an optoelectronic device, its disassembly is prohibited.

Description

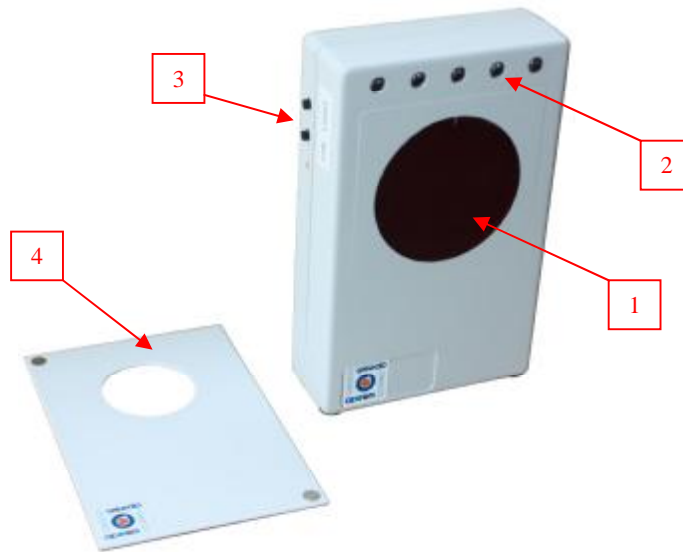

- | | |
|-----------------------|-------------------|
| 1) Hit zone | 3) Controls |
| 2) Integrated display | 4) Reduction area |

Purpose

Target is designed to detect the transmitted laser beam laser guns after pulling the trigger. Target detects the laser beam carrying the code UIPM. Target evaluates hit in the Hit zone and the course of fire shown on the integrated display.

Preparation for Operating

Targets to insert the batteries. Use 2 pieces of AAA batteries. When inserting the batteries, you must observe polarity.

Press the ON button to turn on the power detector. Targets supply is indicated by LEDs. Target turns off automatically when it is idle for more than 5 minutes.

After turning detector performs a battery test and then test the integrated display.



Hit into the Hit zone lights integrated display. At this point you can adjust the brightness of the integrated display. Press BRIGHT. Each press will change the brightness of the lights on the integrated display. You can set up to 10 levels of brightness. Adjusting the brightness of the display can be done at any time when lights integrated display.

Hit zone size is reduced to a distance of 8 meters, the reducing area is designed for shooting from 4 m.

APEOM s.r.o.





Rules of Operation

Position the target so as to prevent reflection of the optical beam e.g. from a table, a wall, etc. The location must also be such as to not causing reflection unwanted light on the target. The location must be such that the target lighting surfaces evenly, without shadows.

Never use a target if it is damaged.

Battery check:

When turned on, the targeting board starts making an audio signal, indicating that the battery check is underway. Watch the integrated display.

	Batter capacity approx. – 80%
	Batter capacity approx. – 60%
	Batter capacity approx. – 40%
	Batter capacity approx. – 20%
	The batteries are depleted, replace them immediately!

If the batteries are depleted, the audio signal comes up – 10 x BEEP.

Maintenance

Keep the device in clean environment and away from dust. Clean using a dry cloth; do not use any chemical agents or alcohol-based detergents.

Possible Defects and How to Fix Them

The targeting board does not evaluate hits	Check if the correct beam is send by the emitter or check the power supply.
Other defects	Contact the provider.

Technical Specificacions

Name	Value
- firing range	8 m with area reduction of 4 meters
- power supply	3 V DC (2x1,5V AAA)
- dimensions	118 x 74 x 29 mm
- weight	0,15 kg
- working temoerature	+5°C až 40°C
- lighting	max. 70 000 Lux
- evalution	Hit
- input data format	UIPM Open target protocol (laser signal 15.6 ms)

Other Information

The target is equipped with a serial number plate and sealing stickers. Damaging the marking plate or the labels voids the warranty.

Batteries do not belong in the trash. Take the batteries to collection points.