

## TARGET Hit/Miss v15

### INSTRUCTION MANUAL

#### 1. Safety Precautions.

- Please read the Instruction Manual carefully prior to using the device.
- Use the device only as described in this Instruction Manual.
- The device shall only be used for its designated purpose.
- Never aim at people, animals or to an uncontrolled area.
- When handling the gun, adhere to the general rules related to handling guns.
- Target Hit/Miss v15 is an opto-electrical device; it is not allowed to dismantle it.
- Never use a damaged power supply to power the detector.
- Secure the data and power supply cables to prevent them from getting caught up to people passing in vicinity of the device.
- Do not use data connectors to connect to computer networks or or to connect other than allowed devices.

#### 2. Description

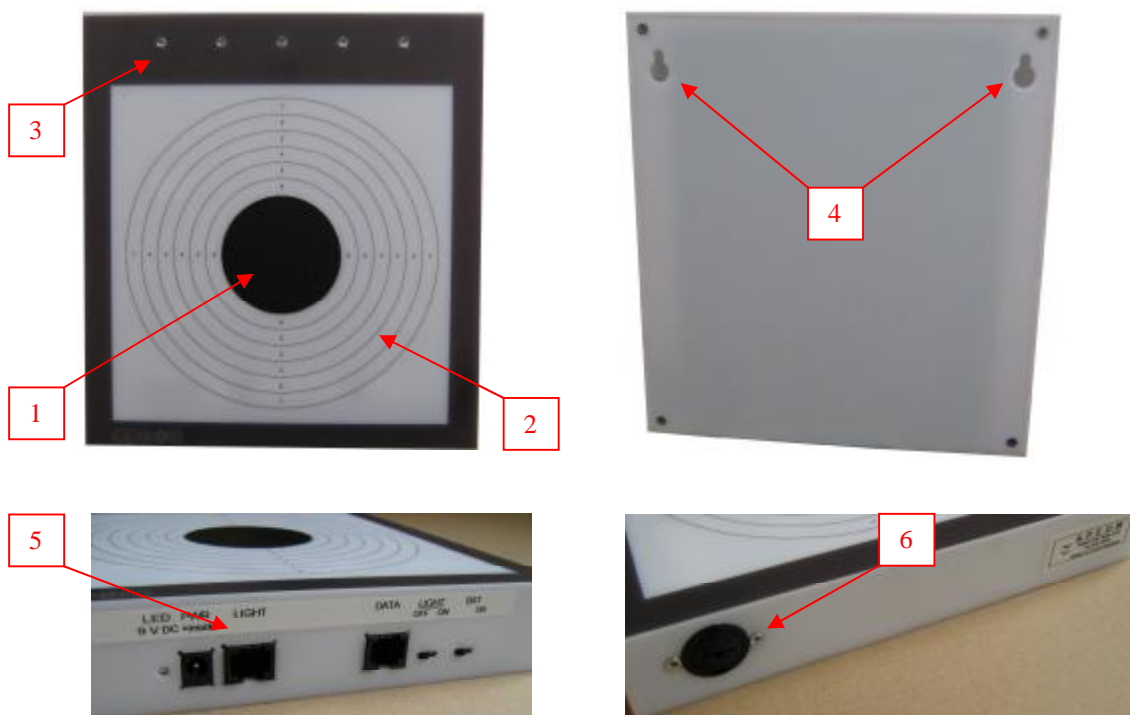

- 1) Hit zone
- 2) Miss zone
- 3) Integrated display
- 4) Attachment openings for the targeting board

- 5) Control panel
- 6) Battery holder

#### 3. Purpose

The purpose of the targeting board is to detect the laser beam sent by the laser gun after pulling the trigger. The targeting board detects the laser beam that carries a piece of UIPM code, evaluating whether it connected with the Hit or Miss zone, as well as measuring the shooting time.

APEOM s.r.o.



**Adresa**  
Mirová 24  
703 00 Ostrava 3  
Czech Republic



**Telefonní spojení**  
tel.: +420 596 614 795



**Identifikační číslo**  
IČO: 25876911  
DIČ: CZ25876911



**E-mail**  
[info@apeom.cz](mailto:info@apeom.cz)  
[www.apeom.cz](http://www.apeom.cz)  
[youtube.com/apeomcz](https://youtube.com/apeomcz)



**Společnost zapsaná**  
v ob. rejst. vedeném  
u KS v Ostravě,  
oddíl C, vložka 23877

#### 4. Preparation for Operation

Insert batteries into the targeting board. Use 3 AA batteries. Pay attention to the polarity when inserting the batteries. To power the targeting board from batteries, turn the BAT switch to ON. On the integrated display, LED diodes indicate the battery status by flashing and perform a functionality check for green and red LED lights. As soon as you are done shooting, turn the BAT switch off.

The targeting board can be powered via its 9 V DC 2.1/5.5 + built-in power source. The BAT switch must not be in the ON position if you are using the power source. The power source is not included with the targeting board.



The spacing between the targeting board's attachment openings is 170 mm.

#### 5. Basics of Operation

When changing batteries, press onto the lid and turn it counter-clockwise.

Never use a damaged targeting board. Never use a power source with damaged cover, insulations, powering connector or cable.

Connectors LIGHT and DATA may not be used to connect the targeting board to a computer network.

The LIGHT may only be used to connect the NAVISTREET external display. Do NOT use it to connect other displays!

When using the targets in the interior, it is recommended to follow the rules of the ISSF to illuminate targets.

Battery check:

When turned on, the targeting board starts making an audio signal, indicating that the battery check is underway. Watch the integrated display.



Batter capacity approx. – 80%



Batter capacity approx. – 60%



Batter capacity approx. – 40%



Batter capacity approx. – 20%



The batteries are depleted, replace them immediately!

If the batteries are depleted, the audio signal comes up – 10 x BEEP.

## 6. Maintenance

Keep the device in clean environment and away from dust. Clean using a dry cloth; do not use any chemical agents or alcohol-based detergents.

Never use a power source with damaged cover, insulations, powering connector or cable.

## 7. Possible Defects and How to Fix Them

The targeting board does not evaluate hits	Check if the correct beam is send by the emitter or check the power supply of the targeting board.
The targeting board makes 10 beeping sounds	Turn the power supply off immediately and replace the batteries.
Other defects	Contact the provider.

## 8. Technical Specifications

Name	Value
- Firing range	10 m
- Power supply	4.5 V (3x1.5V AA) or 9V DC 2.1/5.5 built in power supply
- Dimensions	20 x 22 x 3.5 cm
- Weight	0.67 kg
- Working temperature	+5°C to 40°C
- Lighting	max. 70 000 Lux
- Evaluation	Hit, Miss
- Input data format	UIPM Open target protocol (laser signal 15.6 ms)

## 9. Other Information

The target is equipped with a serial number plate and sealing stickers. Damaging the marking plate or the labels voids the warranty.